





1-800-BOLLARDS

The Bollard Experts

- SELECT DESIRED MATERIAL:
(6" NOMINAL SIZE)
 - RPCSCT06040 SCH 40 STAINLESS STEEL
 - RPCSCT06040 SCH 40 ASTM A-53 CARBON STEEL
- SELECT DESIRED STAINLESS STEEL BOLLARD FINISH:
 - POLISHED #4 FINISH
 - AS SPECIFIED _____
- SELECT DESIRED CARBON STEEL BOLLARD FINISH:
 - POWDERCOAL RAL # _____
 - AS SPECIFIED _____
- SELECT DESIRED STAINLESS STEEL BOLLARD MATERIAL:
 - TYPE 304
 - TYPE 316
- SELECT DESIRED BOLLARD CAP STYLE:
 -  DOME
 -  STANDARD FLAT
 -  REVEAL
 -  SLOPED

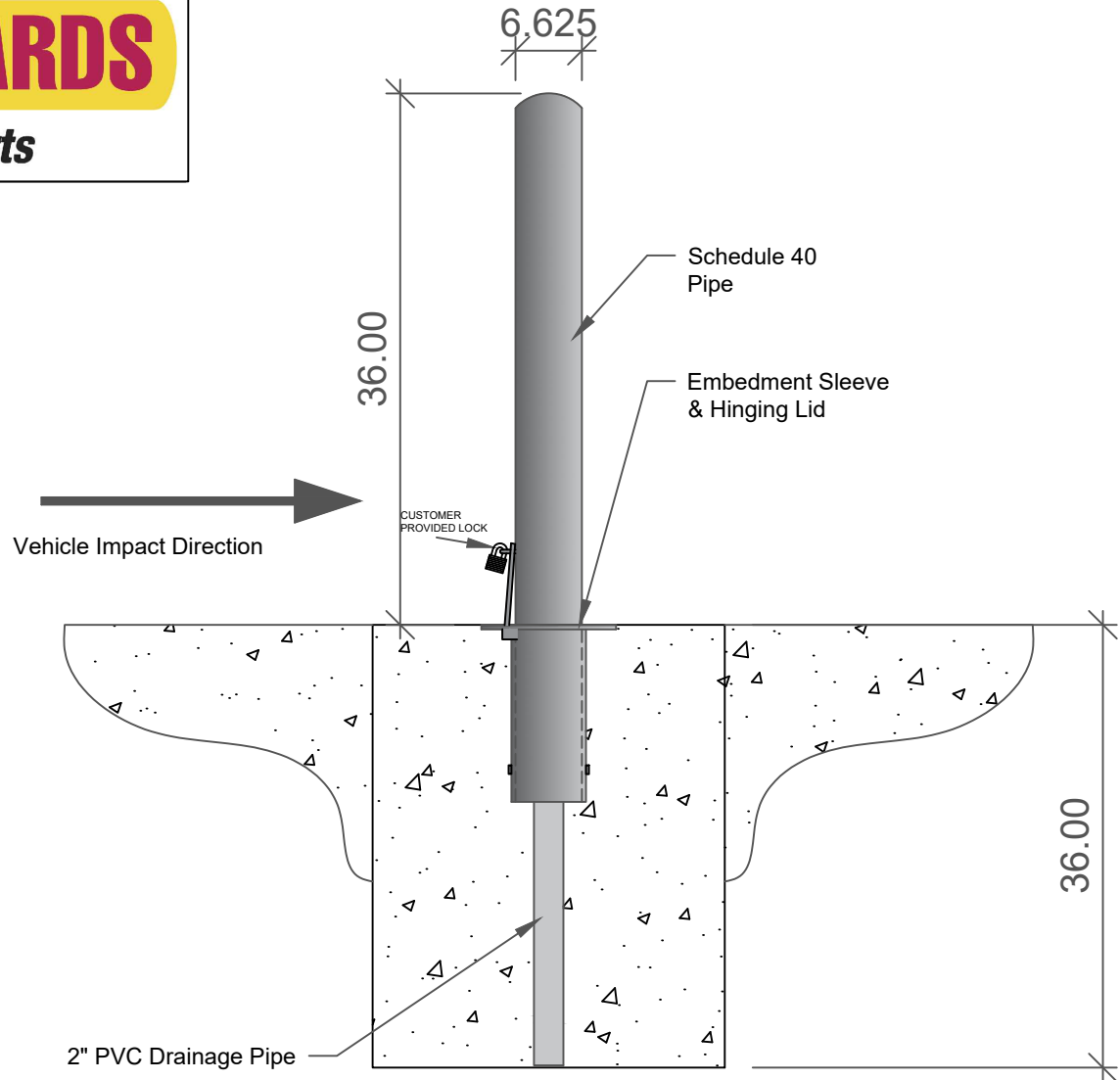

REVISIONS			
LTR	DESCRIPTION	DATE	APPVD
COMMENTS			
SPECIFICATIONS			
HEIGHT: 36"			
DIAMETER: 6.625"			
WALL THICKNESS: 0.280"			

END VIEW-FOUNDATION

DOME STANDARD FLAT REVEAL SLOPED

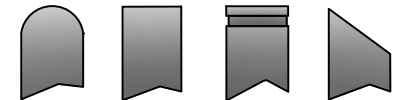

APPLICATION	
NEXT ASSY	USED ON

SERIES NUMBER: XX-S060-XX	CAGE CODE: 6NGJ8	REV: 6" CT REMOVABLE	DRAWING NUMBER: 6" CT REMOVABLE
PRODUCT FAMILY: 20 MPH CRASH TESTED	DRAWN BY: AJA	DRAWING REV:	
PRODUCT CLASS: STANDARD OR CUSTOMER DEFINED	CHECKED BY:	SHEET: 1 OF 1	
PRODUCT LINE: BOLLARD	APPROVED BY:	RELEASE DATE:	
PRODUCT SUB LINE: REMOVABLE	1-800-BOLLARDS, Inc. 10 Hughes Suite A105 Irvine, CA 92618 PHONE: 1-800-BOLLARDS WEB: WWW.1800BOLLARDS.COM EMAIL: INFO@1800BOLLARDS.COM		
BOLLARD, CT REMOVABLE			





1. THIS DRAWING IS TO BE COMPLETED IN ACCORDANCE WITH MANUFACTURER'S SPECIFICATIONS.
2. DO NOT SCALE DRAWING.
3. THIS DRAWING IS INTENDED FOR USE BY ARCHITECTS, ENGINEERS, CONTRACTORS, GENERAL TRADES AND DESIGN PROFESSIONALS FOR PLANNING AND INSTALLATION PURPOSES.
4. ALL INFORMATION CONTAINED HEREIN WAS CURRENT AT THE TIME OF DEVELOPMENT BUT MUST BE REVIEWED AND APPROVED BY THE PRODUCT MANUFACTURER TO BE CONSIDERED ACCURATE.

1-800-BOLLARDS

The Bollard Experts

REVISIONS			
LTR	DESCRIPTION	DATE	APP
COMMENTS			

SPECIFICATIONS
 HEIGHT: 36"
 DIAMETER: 6.625"
 WALL THICKNESS: 0.280"

- SELECT DESIRED MATERIAL: (6" NOMINAL SIZE)
 - RPCSCT06040 SCH 40 STAINLESS STEEL
 - RPCSCT06040 SCH 40 ASTM A-53 CARBON STEEL
- SELECT DESIRED STAINLESS STEEL BOLLARD FINISH:
 - POLISHED #4 FINISH
 - AS SPECIFIED _____
- SELECT DESIRED CARBON STEEL BOLLARD FINISH:
 - POWDERCOAL RAL # _____
 - AS SPECIFIED _____
- SELECT DESIRED STAINLESS STEEL BOLLARD MATERIAL:
 - TYPE 304
 - TYPE 316
- SELECT DESIRED BOLLARD CAP STYLE:
 -  DOME
 -  STANDARD FLAT
 -  REVEAL
 -  SLOPED

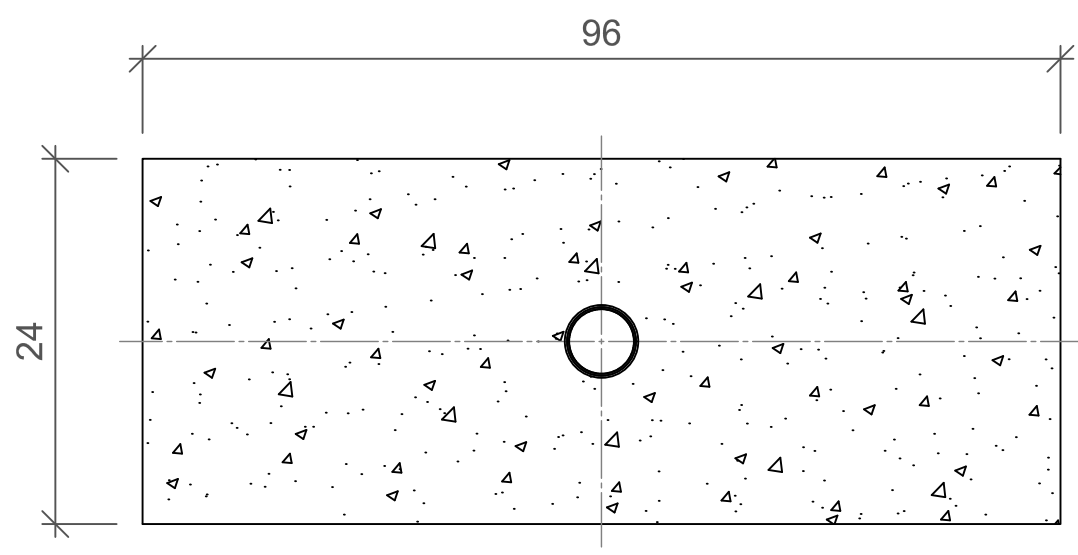

PLAN VIEW-FOUNDATION

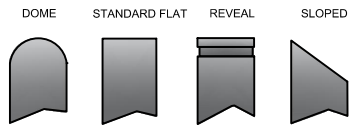





NOTES:
 1. THIS DRAWING IS TO BE COMPLETED IN ACCORDANCE WITH MANUFACTURER'S SPECIFICATIONS.
 2. THE FINISHES AND MATERIALS LISTED ARE SUGGESTIONS ONLY. THE CUSTOMER'S SPECIFICATIONS SHALL TAKE PRECEDENCE OVER THE MANUFACTURER'S SPECIFICATIONS.
 3. THE FINISHES AND MATERIALS LISTED ARE SUGGESTIONS ONLY. THE CUSTOMER'S SPECIFICATIONS SHALL TAKE PRECEDENCE OVER THE MANUFACTURER'S SPECIFICATIONS.
 4. THE FINISHES AND MATERIALS LISTED ARE SUGGESTIONS ONLY. THE CUSTOMER'S SPECIFICATIONS SHALL TAKE PRECEDENCE OVER THE MANUFACTURER'S SPECIFICATIONS.
 5. THE FINISHES AND MATERIALS LISTED ARE SUGGESTIONS ONLY. THE CUSTOMER'S SPECIFICATIONS SHALL TAKE PRECEDENCE OVER THE MANUFACTURER'S SPECIFICATIONS.
 6. THE FINISHES AND MATERIALS LISTED ARE SUGGESTIONS ONLY. THE CUSTOMER'S SPECIFICATIONS SHALL TAKE PRECEDENCE OVER THE MANUFACTURER'S SPECIFICATIONS.

APPLICATION		1-800-BOLLARDS, Inc. 10 Hughes Suite 1100 Irvine, CA 92618 PHONE: 1-800-BOLLARDS WEB: WWW.1800BOLLARDS.COM EMAIL: INFO@1800BOLLARDS.COM		DATE CODE 6N0J10		REV 6" CT REMOVABLE		DRAWING NUMBER 6" CT REMOVABLE	
NEXT ASSY	USED IN	STANDARD OR CUSTOMER DEFINED		DRAWN BY: AJA		CHECKED BY:		DRAWING REV: A	
		REMOVABLE		CREATED BY:		APPROVED BY:		SHEET 1 OF 1	
								RELEASE DATE:	
								TITLE: BOLLARD, CT REMOVABLE	

1-800-BOLLARDS

The Bollard Experts

REVISIONS			
LTR	DESCRIPTION	DATE	APPVD
COMMENTS			
SPECIFICATIONS			
HEIGHT: 36"			
DIAMETER: 6.625"			
WALL THICKNESS: 0.280"			

- SELECT DESIRED MATERIAL:
(6" NOMINAL SIZE)
 - RPCSCT06040 SCH 40 STAINLESS STEEL
 - RPCSCT06040 SCH 40 ASTM A-53 CARBON STEEL
- SELECT DESIRED STAINLESS STEEL BOLLARD FINISH:
 - POLISHED #4 FINISH
 - AS SPECIFIED _____
- SELECT DESIRED CARBON STEEL BOLLARD FINISH:
 - POWDERCOAL RAL # _____
 - AS SPECIFIED _____
- SELECT DESIRED STAINLESS STEEL BOLLARD MATERIAL:
 - TYPE 304
 - TYPE 316
- SELECT DESIRED BOLLARD CAP STYLE:
 -  DOME
 -  STANDARD FLAT
 -  REVEAL
 -  SLOPED

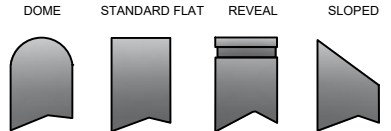
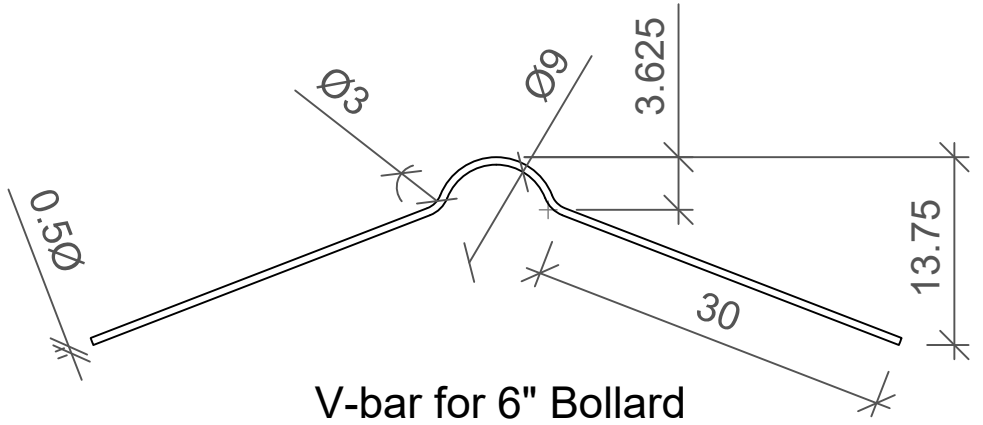
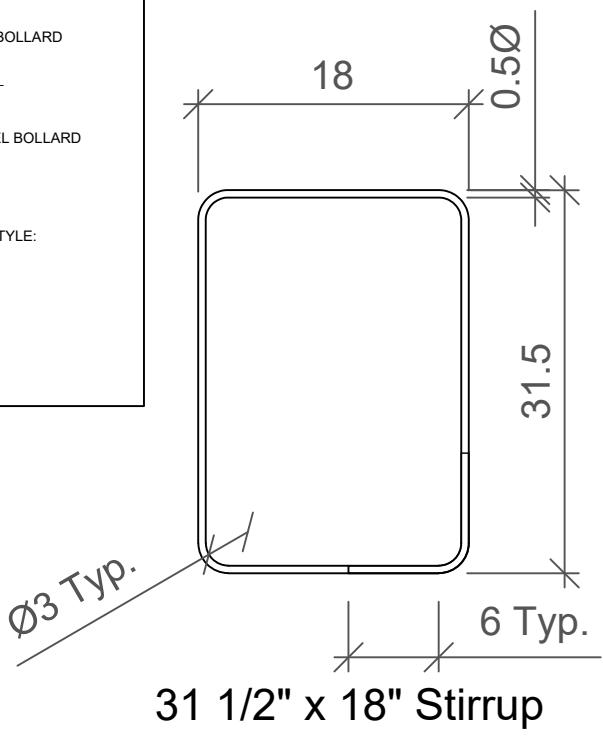

1. INSTALLATION TO BE COMPLETED IN ACCORDANCE WITH MANUFACTURER'S SPECIFICATIONS.
 2. THIS DRAWING IS INTENDED FOR USE BY ARCHITECTS, ENGINEERS, CONTRACTORS, CONSULTANTS AND DESIGN PROFESSIONALS FOR PLANNING AND INSTALLATION PURPOSES.
 3. ALL DIMENSIONS SHOWN HEREIN ARE CURRENT AS OF THE TIME OF DEVELOPMENT BUT MUST BE REVIEWED AND APPROVED BY THE PRODUCT MANUFACTURER TO BE CONSIDERED ACCURATE.

APPLICATION		SERIES NUMBER: XX-S060-XX		CAGE CODE	SIZE	DRAWING NUMBER:	
NEXT ASSY	USED ON	PRODUCT FAMILY:	20 MPH CRASH TESTED	6NGJ8	6"	6" CT REMOVABLE	
		PRODUCT CLASS:	STANDARD OR CUSTOMER DEFINED	DRAWN BY:	AJA	DRAWING REV:	
		PRODUCT LINE:	BOLLARD	CHECKED BY:		SHEET 1 OF 1	
		PRODUCT SUB LINE:	REMOVABLE	APPROVED BY:		RELEASE DATE:	
		1-800-BOLLARDS, Inc. 10 Hughes Sutte Al05 Irvine, CA 92618 PHONE: 1-800-BOLLARDS WEB: WWW.1800BOLLARDS.COM EMAIL: INFO@1800BOLLARDS.COM				TITLE: BOLLARD, CT REMOVABLE	